

Cartidge Bearing Threadless Headset Instruction Manual

Please read all instructions before installing your new threadless headset.

Note: Installation requires specialized equipment to press fittings on to the steerer tube and in to the head tube.

Warning

Failure to install headset properly may result in damage to your bicycle, serious injury, and/or death.

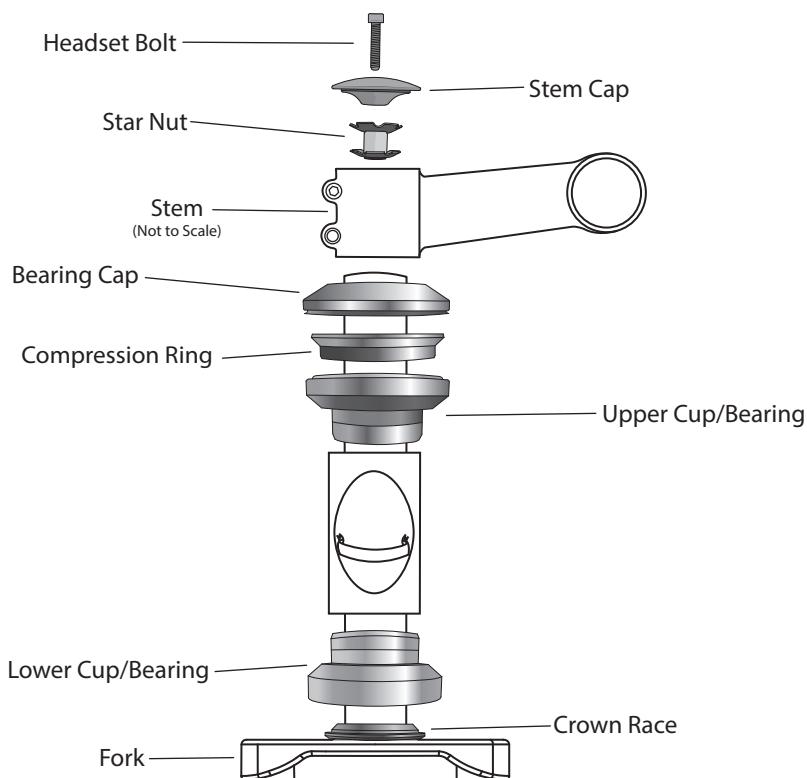

Note: This headset contains 2 different sizes of crown race, 26.4mm and 27mm. Be sure to check the fork for appropriate sizing.

Installation

1. Install applicable crown race on to the fork using an appropriate press.
Fitment should be flush and evenly seated.
2. Remove the bearings from the cups, then install the upper and lower cups in to the head tube using a headset press, and then replace the bearings.
3. Using a star nut setter, install the star nut in to the steerer tube.
4. Insert fork through the head tube and install compression ring and bearing cap.
Compression ring split should be on the side of the steerer tube, NOT the front.
5. Place stem and any spacers (Not included) on to steerer tube to set desired height.
6. Install the stem cap and headset bolt.
7. Check that all fittings are flush with their respective mounting surfaces and that rotation is smooth.